

3.3m rotating tilt umbrella

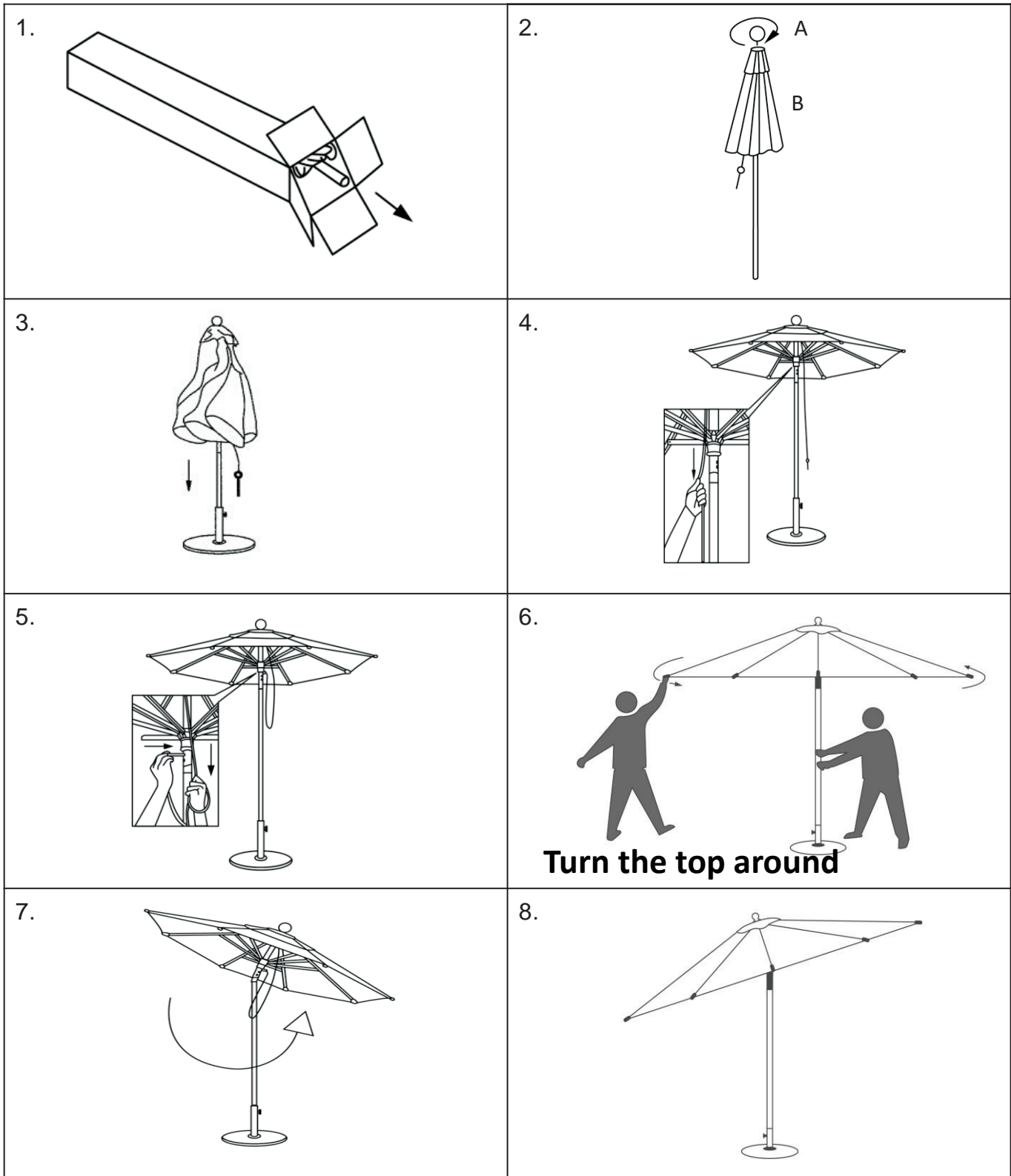

Husk at slå parasollen ned, når den ikke er i brug. NB! skal være tør inden den slås sammen og iføres evt. parasol betræk. Det anbefales at parasollen bliver lagt ned, når det blæser. Da stok og pinde kan tage skade ved et fald.

Cover must be dry before closing. To extend lifetime and to avoid bleach from the sun, we recommend using a protective cover.

Do not use the garden umbrella during windy conditions. Ribs and cover may suffer severe damages if it hits the ground. Make sure to close down the garden umbrella, after use.